

defender ^{PRO} wireless gamepad

compatible with
PS1®, PS Classic, PS2®,
PS3®, Switch®, & PC



**RETRO[®]
FIGHTERS**

QUICK START GUIDE

FEATURES

**DUAL
MODE**

2.4GHz & BT WIRELESS

PRESSURE SENSITIVE BUTTONS



true to form analog input

ENHANCED DPAD PERFORMANCE



smoother, and more precise input



available in BT mode only

**ANTI-FRICTION
RINGS**

HALL EFFECT ANALOG STICKS



no drift, high precision, unmatched durability

the ultimate RETRO experience

30+ Ft.
WIRELESS RANGE

TRIGGER LOCKS

swap between analog or digital trigger action

BACK GRIP BUTTONS

assign custom commands for a competitive edge

1000Hz
POLLING RATE

ULTRA
COMPATIBILITY

IMMERSIVE VIBRATION

fully adjustable rumble feedback

CONTROLLER LAYOUT

get to know your controller



PAIRING INSTRUCTIONS

sync up and get ready to play

2.4
GHZ
WIRELESS

Make sure your receivers are plugged in securely and in pairing mode

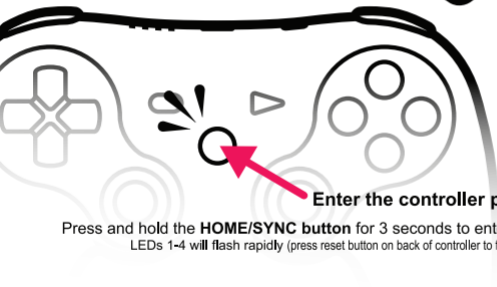
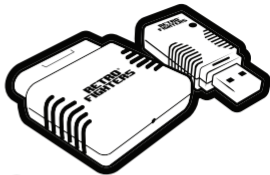

Enter the controller pairing mode

Press and hold the **HOME/SYNC** button for 3 seconds to enter pairing mode
LEDs 1-4 will flash rapidly (press reset button on back of controller to force new connections)

Wait for a stable LED light on controller for successful pairing

PAIRING INSTRUCTIONS

sync up and get ready to play



BT PS3 Mode

Connect with cable to console to pair, unplug and press home to reconnect

BT Switch Mode

Hold Pairing Button

BT X-Input mode

Hold **O** + Pairing Button

BT D-Input Mode

Hold Pairing Button

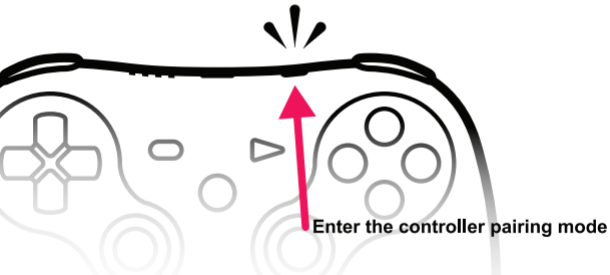

Enter the controller pairing mode

Wait for a stable LED light on controller for successful pairing

MAKE SURE YOUR CONSOLE OR PC IS IN BT DISCOVERY MODE BEFORE PAIRING



Input Mode Swapping:

- Swap freely from **X** and **D-Input** modes. Hold **SELECT + START** for three seconds to swap modes.
- Please note that for ease of use across all devices outside of **PS1/2/3**, usually the best option is to use the **X-Input** mode.

Back Button Programming:

- This allows you to map an input to **PR** or **PL** buttons on the back of the controller
 - Press the **SELECT** button and **PR** buttons (or **PL**)
 - Press the button you want to map to **PR** (or **PL**)
 - Press the same back button again to confirm the mapping
 - Vibration will confirm mapping was successful
 - To clear an assigned button hold **SELECT** and **PR** (or **PL**) then press **PR** (or **PL**) again. Vibration will confirm the macro is now cleared

Digital and Analog Modes:

- Hold the **HOME** button to swap between analog and digital modes for best use on **PS1** games.

Rumble Intensity Adjustment:

- Freely increase and decrease the rumble intensity with this simple macro.
 - Hold **START + LS (UP/DOWN)** to cycle rumble intensity (four levels)
 - Default level is 70% strength

Trigger/Shoulder Swap Mode:

- This mode swaps **R1/R2** or **L1/L2** buttons respectively. This macro is especially useful for users to have both needed game inputs on the same row (**R2/L2** or **R1/L1**).
 - Press **SELECT** and then hold **R1 + R2** for 3 seconds
 - Press **SELECT** and then hold **L1 + L2** for 3 seconds

Turbo Function Modes:

- Save yourself the strain of spamming button presses with these handy macros. This controller fully supports a hold to turbo and automatic turbo modes
- **Standard Turbo Mode** - hold **SELECT + DPAD DOWN + X** (ex. button for turbo output)
- **Automatic Turbo Mode** - after a button is set in standard mode (ex. **X** has been set above) repeat **SELECT + DPAD DOWN + X**
- **Clearing Turbo Mode** - repeat **SELECT + DPAD DOWN + X** (ex.) and button output will return to normal

Analog Stick Modes:

- The original controllers had a different output curve compared to most modern pro controllers. This macro allows free switching between modes.
 - Hold **□ + START + SELECT**
 - Motors will rumble one time for modern mode (circular)
 - Motors will rumble two times for classic mode (square)

RESPONSE CURVE DIAGRAMS



MODERN MODE

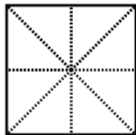

CLASSIC MODE

Stick Recalibration Mode:

- While gamepad is turned on HOLD **SELECT + X + O**
 - LEDs will flash when successful
 - Rotate each stick three times and press **L2/R2** triggers each three times
 - Press the **O** button to save and exit calibration
- Please note that our controllers are calibrated at the factory and this should only be used if you are experiencing gameplay altering issues

BUTTON MAPPING GUIDE

platform / mode specific input

	X-INPUT	D-INPUT	PS1/PS2/PS3	Switch
LS	LS	LS	LS	LS
L3	L3	L3	L3	L3
RS	RS	RS	RS	RS
R3	R3	R3	R3	R3
HOME	HOME	HOME	HOME (PS3)	HOME
START	START	START	START	START / +
SELECT	SELECT	SELECT	SELECT	SELECT / -
X	A	A	X	B
O	B	B	O	A
□	X	X	□	Y
△	Y	Y	△	X
DPAD	DPAD	DPAD	DPAD	DPAD
R1	RB	RB	R1	R
R2	RT	RT	R2	ZR
L1	LB	LB	L1	L
L2	LT	LT	L2	ZL

LED GUIDE

understanding all LED patterns

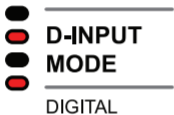

COMPATIBILITY

what can I use this thing with?

	2.4GHz (USB)		2.4GHz (Retro)	
	BT Connection			Wired Connection
PS1	✗	✗	✓	✗
PS2	✗	✗	✓	✗
PS3	✓	✓	✗	✓
PS Classic	✗	✓	✗	✗
Windows PC	✓	✓	✗	✓
Steam / Deck	✓	✓	✗	✓
Switch	✓	✓	✗	✓
MiSTer FPGA	✓	✓	✗	✓

RETRO[®] FIGHTERS

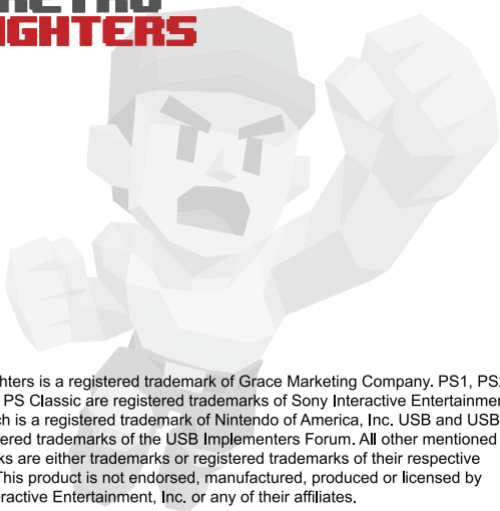

Retro Fighters is a registered trademark of Grace Marketing Company. PS1, PS2, PS3, and PS Classic are registered trademarks of Sony Interactive Entertainment, Inc. Switch is a registered trademark of Nintendo of America, Inc. USB and USB-C are registered trademarks of the USB Implementers Forum. All other mentioned trademarks are either trademarks or registered trademarks of their respective owners. This product is not endorsed, manufactured, produced or licensed by Sony Interactive Entertainment, Inc. or any of their affiliates.

©Copyright Grace Marketing Company

My controller is not connecting to the dongle.

- Remove the dongle from the system/PC and reset the gamepad by pressing the pairing button button. Reinsert the dongle and retry the complete pairing process.

Why isn't my controller working properly on Steam?

- You may need to enable "Steam Input" within Steam's settings.

I have other questions. Who do I contact?

- Reach out to us at support@retrofighters.com. We're here to help!

CUSTOMER SERVICE

We strive to make our fellow gamers happy. If you experience any issues with this product please contact us directly. We are here to help and will make it right! You can email us at:

SUPPORT@RETROFIGHTERS.COM

